

ERF6020, RF connector, U.FL connector, PCB Mount

Features

Mechanical Properties

Parameter:	Description
Connector Type:	U.FL
Dimensions:	3 x 3 x 1.25 mm ± 0.1
Operating Temperature Range:	-40°C~+90°C
Storage Temperature Range:	-40°C~+90°C
Impedance:	50 Ω
Frequency Range:	0 – 6GHz

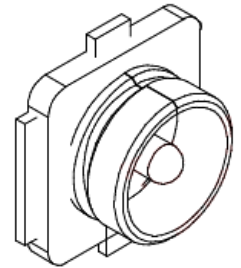

Description

The ERF6020 is a RF connector suitable for RF applications. The connector is a U.FL PCB mount connector. It can be used for RF connections and as antenna connector.

Typical applications

- RF connections
- Antenna connector
- Antenna cable connector

Dimensions

*unit: mm

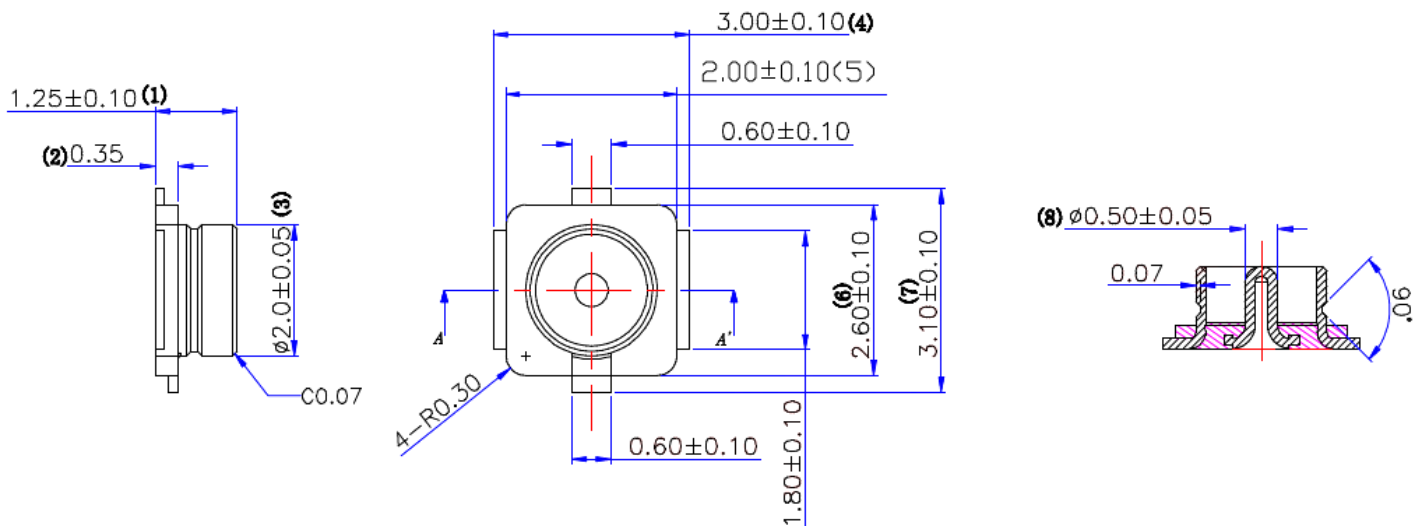

Part	Description	Material	Finish
1	Housing	LCP UL94	White
2	Contact pin	Brass (C2680-H)	Gold plated
3	Shell	Phosphor bronze (C5191-H)	Gold plated

ERF6020, RF connector, U.FL connector, PCB Mount

PCB Footprint

*unit: mm

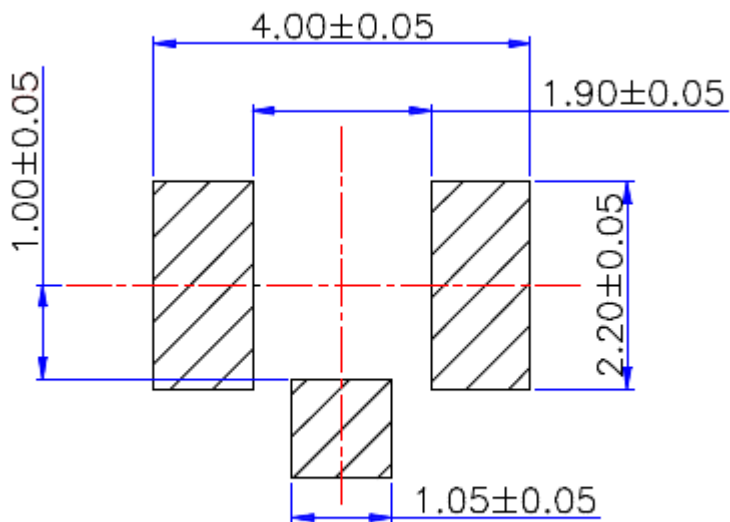

PCB LAYOUT

Ordering information

Ordering can be done via www.summit-electronics.com or via info@summit-electronics.com. Please contact us for more information. Customisation of the product is available on request.

Technical support

For all product questions please contact us via info@summit-electronics.com